



VHF MARINE TRANSCEIVER

IC-M23

Icom Inc.



DOC



CE versions of the IC-M23 which display the “CE” symbol on the serial number label, comply with the essential requirements of the European Radio and Telecommunication Terminal Directive 1999/5/EC.



This warning symbol indicates that this equipment operates in non-harmonised frequency bands and/or may be subject to licensing conditions in the country of use. Be sure to check that you have the correct version of this radio or the correct programming of this radio, to comply with national licensing requirement.

• List of Country codes (ISO 3166-1)

	Country	Codes		Country	Codes
1	Austria	AT	18	Liechtenstein	LI
2	Belgium	BE	19	Lithuania	LT
3	Bulgaria	BG	20	Luxembourg	LU
4	Croatia	HR	21	Malta	MT
5	Czech Republic	CZ	22	Netherlands	NL
6	Cyprus	CY	23	Norway	NO
7	Denmark	DK	24	Poland	PL
8	Estonia	EE	25	Portugal	PT
9	Finland	FI	26	Romania	RO
10	France	FR	27	Slovakia	SK
11	Germany	DE	28	Slovenia	SI
12	Greece	GR	29	Spain	ES
13	Hungary	HU	30	Sweden	SE
14	Iceland	IS	31	Switzerland	CH
15	Ireland	IE	32	Turkey	TR
16	Italy	IT	33	United Kingdom	GB
17	Latvia	LV			

	DECLARATION OF CONFORMITY
<p>We Icom Inc. Japan 1-1-32, Kamiminami, Hirano-ku Osaka 547-0003, Japan</p>	
<p>Declare on our sole responsibility that this equipment complies with the essential requirements of the Radio and Telecommunications Terminal Equipment Directive, 1999/5/EC, and that any applicable Essential Test Suite measurements have been performed.</p>	
<p>Kind of equipment: VHF MARINE TRANSCEIVER</p>	<p>CE 0560 ⓘ</p>
<p>Type-designation: IC-M23</p>	<p>Bad Soden 31st Jan. 2011 Place and date of issue</p>
<p>Version (where applicable):</p> <p>This compliance is based on conformity with the following harmonised standards, specifications or documents:</p> <p>i) EN 301 178-2 V1.2.2 (2007-02)</p> <p>ii) EN 60945:2002</p> <p>iii) EN 60950-1:2006/A11:2009</p> <p>iv) EN 300 698-2 V1.2.1 (2009-12)</p> <p>v) EN 300 698-3 V1.2.1 (2009-12)</p> <p>vi) _____</p>	<p>Icom (Europe) GmbH Communication Equipment Auf der Krautweide 24, 65812 Bad Soden am Taunus, Germany</p> <p>Authorized representative name</p> <p>Y. Furukawa General Manager</p> <p></p> <p>Signature</p>
<p>Icom Inc.</p>	

IN CASE OF EMERGENCY

If your vessel requires assistance, contact other vessels and the Coast Guard by sending a distress call on Channel 16.

○ **USING CHANNEL 16**

DISTRESS CALL PROCEDURE

1. "MAYDAY MAYDAY MAYDAY."
2. "THIS IS " (name of vessel)
3. Your call sign or other description of the vessel.
4. "LOCATED AT " (your position)
5. The nature of the distress and assistance required.
6. Any other information which might facilitate the rescue.

RECOMMENDATION

CLEAN THE TRANSCEIVER THOROUGHLY WITH FRESH WATER after exposure to saltwater, and dry it before operating. Otherwise, the transceiver's keys, switches and controllers may become unusable due to salt crystallization.

NOTE: DO NOT submerge the transceiver in water if there is any reason to suspect the waterproof protection may not be effective. For example, in cases where the battery cover or [DC] jack cap rubber seal is damaged, the transceiver/battery cover/[DC] jack cap is cracked or broken, or the transceiver has been dropped, or when the battery cover, antenna or DC Jack cap are detached from the transceiver.

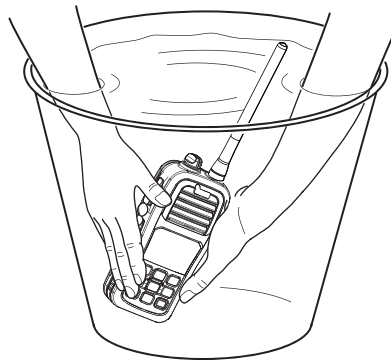

FOREWORD

Thank you for purchasing this Icom radio. The IC-M23 VHF MARINE TRANSCEIVER is designed and built with Icom's state of the art technology and craftsmanship. With proper care this radio should provide you with years of trouble-free operation.

IMPORTANT

READ ALL INSTRUCTIONS carefully and completely before using the transceiver.

SAVE THIS INSTRUCTION MANUAL—This instruction manual contains important operating instructions for the IC-M23.

EXPLICIT DEFINITIONS

WORD	DEFINITION
⚠ DANGER!	Personal death, serious injury or an explosion may occur.
⚠ WARNING!	Personal injury, fire hazard or electric shock may occur.
CAUTION	Equipment damage may occur.
NOTE	If disregarded, only inconvenience. No risk of personal injury, fire or electric shock.

FEATURES

Floats on water

The transceiver floats in fresh or salt water even when the supplied accessories are attached.

- When a third-party battery pack, strap, antenna, etc. is used, it may sink.



Floats and flashes

An LED sends out intermittent light from a transparent section on the bottom of the radio, while floating in the water. As the LED light stands out in the dark (like a flashing fishing float), the radio can be easily retrieved from the water. This function works even when the radio is turned OFF.



PRECAUTIONS

⚠ WARNING! NEVER connect the transceiver to an AC outlet. This may pose a fire hazard or result in an electric shock.

⚠ WARNING! NEVER hold the transceiver so that the antenna is closer than 2.5 cm from exposed parts of the body, especially the face or eyes, while transmitting. The transceiver will perform best if the microphone is 5 to 10 cm away from the lips and the transceiver is vertical.

CAUTION: NEVER connect the transceiver to a power source other than the BC-199 or BP-266. Such a connection will ruin the transceiver.

DO NOT use or place the transceiver in direct sunlight or in areas with temperatures below -15°C or above $+55^{\circ}\text{C}$.

KEEP the transceiver out of the reach of children.

KEEP the transceiver at least 0.9 meters away from your vessel's magnetic navigation compass.

BE CAREFUL! The transceiver meets IPX7* requirements for waterproof protection. However, once the transceiver has been dropped, waterproof protection cannot be guaranteed because of possible damage to the transceiver's case or the waterproof seal.

* Only when the flexible antenna, battery cover and [DC] jack cap are securely attached.

MAKE SURE the flexible antenna and battery cover are securely attached to the transceiver, and that the antenna and battery cover are dry before attachment. Exposing the inside of the transceiver to water will result in serious damage to the transceiver.

Icom, Icom Inc. and the Icom logo are registered trademarks of Icom Incorporated (Japan) in Japan, the United States, the United Kingdom, Germany, France, Spain, Russia and/or other countries.

TABLE OF CONTENTS

DOC.....	i
IN CASE OF EMERGENCY	ii
RECOMMENDATION	ii
FOREWORD	iii
IMPORTANT	iii
EXPLICIT DEFINITIONS.....	iii
FEATURES.....	iii
PRECAUTIONS.....	iv
TABLE OF CONTENTS.....	v

1 OPERATING RULES 1

2 SUPPLIED ACCESSORIES AND ATTACHMENTS 2-3

■ Supplied accessories.....	2
■ Attachments.....	2

3 PANEL DESCRIPTION 4-7

■ Front, top and side panels	4
■ Function display	6

4 BASIC OPERATION 8-13

■ Channel selection	8
■ Adjusting the volume level	10
■ Adjusting the squelch level	10
■ Receiving and transmitting	11
■ Call channel programming.....	12
■ Volume Loud function	12
■ Volume Mute function	12
■ Lock function.....	13
■ Monitor function	13

■ Automatic backlighting.....	13
■ AquaQuake Water Draining function.....	13

5 SCAN OPERATION (Except Holland version) 14-15

■ Scan types	14
■ Setting TAG channels	15
■ Starting a scan.....	15

6 DUALWATCH/TRI-WATCH (Except Holland version) 16

■ Description.....	16
■ Operation	16

7 SET MODE..... 17-20

■ Set mode programming	17
■ Set mode items.....	18

8 BATTERY CHARGING 21-25

■ Battery caution.....	21
■ Supplied battery charger	23
■ Optional battery charger.....	23

9 TROUBLESHOOTING 26

10 VHF MARINE CHANNEL LIST..... 27

11 SPECIFICATIONS AND OPTIONS..... 28-29

■ Specifications.....	28
■ Options	29

◇ Priorities

- Read all rules and regulations pertaining to call priorities, and keep an up-to-date copy handy. Safety and distress calls take priority over all others.
- You must monitor Channel 16 when you are not operating on another channel.
- False or fraudulent distress calls are prohibited under law.

◇ Privacy

- Information overheard, but not intended for you, cannot lawfully be used in any way.
- Indecent or profane language is prohibited.

◇ Radio licenses

(1) SHIP STATION LICENSE

You may require a current radio station license before using the transceiver. It is unlawful to operate a ship station which is not licensed, but required to be.

If required, contact your dealer or the appropriate government agency for a Ship-Radiotelephone license application. This government-issued license states the call sign which is your craft's identification for radio purposes.

(2) OPERATOR'S LICENSE

A Restricted Radiotelephone Operator Permit is the license most often held by small vessel radio operators when a radio is not required for safety purposes.

If required, the Restricted Radiotelephone Operator Permit must be posted or kept with the operator. If required, only a licensed radio operator may operate a transceiver.

However, non-licensed individuals may talk over a transceiver if a licensed operator starts, supervises, ends the call and makes the necessary log entries.

A current copy of the applicable government rules and regulations is only required to be on hand for vessels in which a radio telephone is compulsory. However, even if you are not required to have these on hand it is your responsibility to be thoroughly acquainted with all pertinent rules and regulations.

■ Supplied accessories

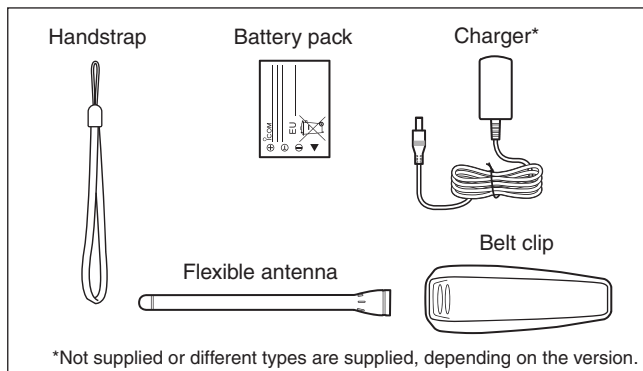

■ Attachments

◇ Flexible antenna

Connect the supplied flexible antenna to the antenna connector.

CAUTION:

- **NEVER** carry the transceiver by holding just the antenna.
- Transmitting without an antenna can damage the transceiver.

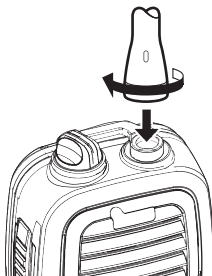

◇ Handstrap

Pass the handstrap through the loop on the back side of the transceiver as shown.

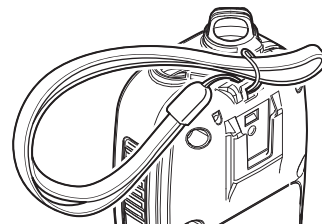

◇ Belt clip

Attach the belt clip to, or detach the belt clip from the transceiver.

To attach the belt clip

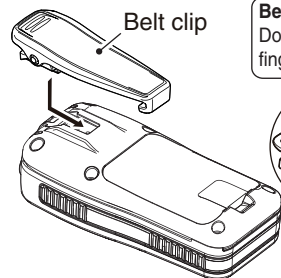

Be careful!
Don't break your fingernail.

To detach the belt clip

Lift the tab up (①), and slide the belt clip in the direction of the arrow (②).

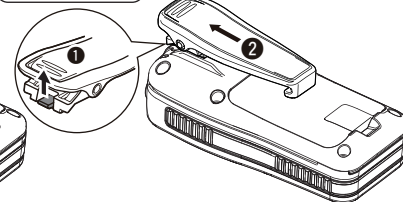

◇ Battery pack

To remove the battery pack:

Slide the latch and then lift the battery cover to remove it. Then remove the battery pack, as shown.

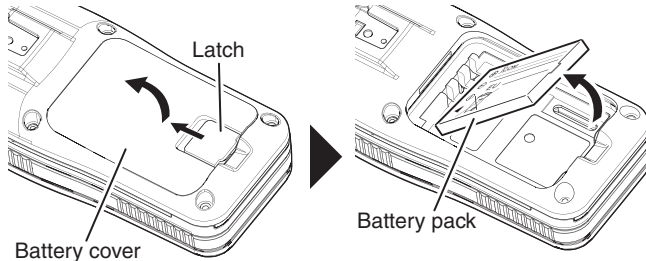

To insert the battery pack:

Place the battery pack into the transceiver so it fits flat, and then securely attach the battery cover, as shown.

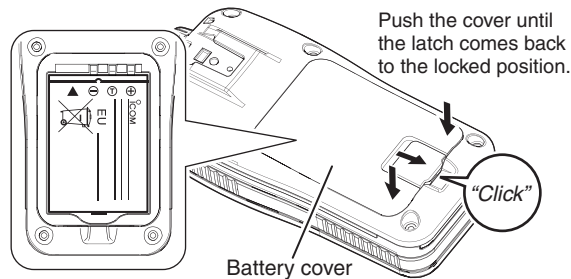

NEVER remove the battery cover when the transceiver is wet or soiled. This may result in water or dust getting into the transceiver/battery pack, and may result in the transceiver being damaged.

CAUTION:

- When attaching or removing the battery cover, make sure the rubber seal is correctly set in the groove of the cover. If the seal is not correctly in the groove, it may be damaged when attaching the battery cover. If the seal is damaged, waterproof protection is not guaranteed.
- When attaching the battery cover, make sure dust or other material does not adhere to the rubber seal. If dust or other material is on the seal when attaching the battery cover, waterproof protection may not be guaranteed.

Make sure the rubber seal is properly seated in the groove and there is dust or other material is on it.

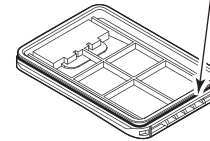

Correct position



Incorrect position

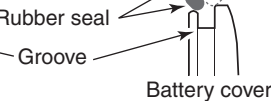

■ Front, top and side panels

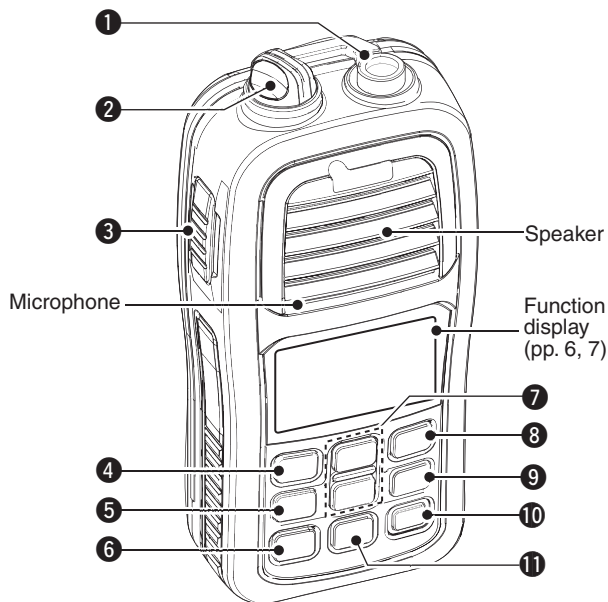

① ANTENNA CONNECTOR (p. 2)

Connect the supplied antenna here.

② DC JACK [DC] (p. 23)

Connect the charger or optional cable here.



① To remove the [DC] jack cap, rotate it counter clockwise.



② Pull the cap up to detach it.

NOTE: Attach the [DC] jack cap when the charger or optional cable is not connected. Otherwise, water will get into the transceiver. When attaching the [DC] jack cap, make sure dust or other material does not adhere to the rubber seal. If dust or other material is on the seal when attaching the cap, waterproof protection may not be guaranteed.

③ PTT SWITCH [PTT]

Hold down to transmit; release to receive. (p. 11)

④ CHANNEL 16 KEY [16 C]

- ➡ Push to select Channel 16. (p. 8)
- ➡ Hold down for 1 second to select the Call channel. (p. 8)
- ➡ When the Call channel is selected, hold down for 3 seconds to enter the Call channel programming mode. (p. 12)
- ➡ While in the Set mode, push to return to the normal operating mode. (p. 17)

Count on us!

< Intended Country of Use >

☐AT ☐BE ☐CY ☐CZ ☐DK ☐EE
☐FI ☐FR ☐DE ☐GR ☐HU ☐IE
☐IT ☐LV ☐LT ☐LU ☐MT ☐NL
☐PL ☐PT ☐SK ☐SI ☐ES ☐SE
☐GB ☐IS ☐LI ☐NO ☐CH ☐BG
☐RO ☐TR ☐HR

A-6925H-1EX
Printed in Japan
© 2011 Icom Inc.

Printed on recycled paper with soy ink.

Icom Inc.

1-1-32 Kamiminami, Hirano-ku, Osaka 547-0003, Japan