



INSTRUCTION MANUAL

COMMUNICATIONS RECEIVER IC-R20

This device complies with Part 15 of the FCC rules. Operation is subject to the following two conditions: (1) This device may not cause harmful interference, and (2) this device must accept any interference received, including interference that may cause undesired operation.

WARNING: MODIFICATION OF THIS DEVICE TO RECEIVE CELLULAR RADIO TELEPHONE SERVICE SIGNALS IS PROHIBITED UNDER FCC RULES AND FEDERAL LAW.

Icom Inc.



FOREWORD

Thank you for purchasing this Icom product. The IC-R20 COMMUNICATIONS RECEIVER is designed and built with Icom's superior technology and craftsmanship. With proper care, this product should provide you with years of trouble-free operation.

We want to take a couple of moments of your time to thank you for making your IC-R20 your radio of choice, and hope you agree with Icom's philosophy of "technology first." Many hours of research and development went into the design of your IC-R20.

◇ FEATURES

- *Covers 0.150–3304.999 MHz* wide frequency range*

*Some frequency bands are inhibited according to version

- *External power supply operation*
- *1250 memory channels* with 26 banks available*

*200 auto write and 50 scan edge channels are included.

- *Built-in bar-antenna*
- *Dualwatch operation*

IMPORTANT

READ ALL INSTRUCTIONS carefully and completely before using the receiver.

SAVE THIS INSTRUCTION MANUAL— This instruction manual contains important operating instructions for the IC-R20.

EXPLICIT DEFINITIONS

WORD	DEFINITION
⚠ WARNING!	Personal injury, fire hazard or electric shock may occur.
CAUTION	Equipment damage may occur.
NOTE	Recommended for optimum use. No risk of personal injury, fire or electric shock.

CE Versions of the IC-R20 which display the "CE" symbol on the serial number seal, comply with the essential requirements of the European Radio and Telecommunication Terminal Directive 1999/5/EC, and that any applicable Essential Test Suite measurements have been performed.

Icom, Icom Inc. and the ICOM logo are registered trademarks of Icom Incorporated (Japan) in the United States, the United Kingdom, Germany, France, Spain, Russia and/or other countries.

PRECAUTION

⚠ WARNING! NEVER operate the receiver with an earphone, headphones or other audio accessories at high volume levels. Hearing experts advise against continuous high volume operation. If you experience a ringing in your ears, reduce the volume level or discontinue use.

⚠ WARNING! NEVER connect the receiver directly to an AC outlet. This may pose a fire hazard or result in an electric shock.

⚠ WARNING! NEVER operate the receiver while driving a vehicle. Safety driving requires your full attention—anything less may result in an accident.

⚠ WARNING! NEVER throw a battery cell or battery pack into a fire since as internal battery gas can cause an explosion.

⚠ WARNING! NEVER disassemble the battery pack. If the battery cell's internal material (electrolyte liquid) gets into your eyes, wash your eyes with water and obtain treatment from an eye doctor immediately.

NEVER connect the receiver directly to a power source of more than 6 V DC. This will damage the receiver.

NEVER connect the receiver to a power source using reverse polarity. This will damage the receiver.

NEVER expose the receiver to rain, snow or any liquids. The receiver may be damaged.

NEVER operate or touch the receiver with wet hands. This may result in an electric shock or damage the receiver.

NEVER solder the battery cell. This may damage the battery.

AVOID using or placing the receiver in direct sunlight or in areas with temperatures below -10°C ($+14^{\circ}\text{F}$) or above $+60^{\circ}\text{C}$ ($+140^{\circ}\text{F}$).

AVOID the use of chemical agents such as benzine or alcohol in cleaning, as they can damage the receiver's surfaces.

Even when the receiver power is OFF, a slight current still flows in the circuits. Remove the battery pack or batteries from the receiver while not using it for a long time. Otherwise, the installed battery pack or batteries will become exhausted, and will need to be recharged.

RESPECT other people's privacy. Information overheard but not intended for you cannot lawfully be used in any way.

For U.S.A. only

CAUTION: Changes or modifications to this device, not expressly approved by Icom Inc., could void your authority to operate this device under FCC regulations.

SUPPLIED ACCESSORIES

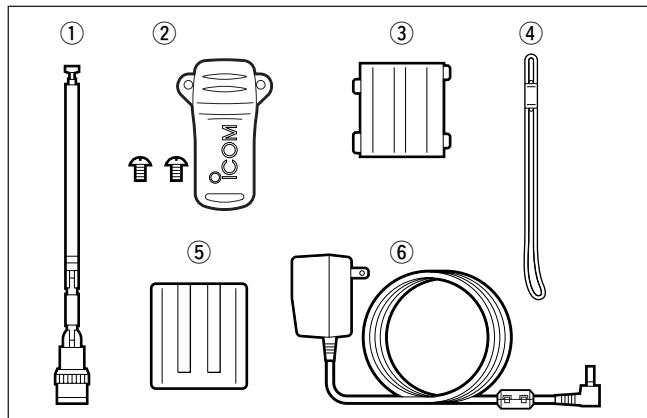

- ① Antenna 1
- ② Belt clip (MB-98) 1 set
- ③ Battery spacer 1
- ④ Hand strap 1
- ⑤ Battery pack* (BP-206) 1
- ⑥ AC adaptor* (BC-149A/D) 1

(The shape of the BC-149A and BC-149D are different.)

*Not supplied with some versions.

OPERATING THEORY

Electromagnetic radiation which has frequencies of 20,000 Hz (20 kHz*) and above is called radio frequency (RF) energy because it is useful in radio transmissions. The IC-R20 receives RF energy from 0.150 MHz* to 3304.999 MHz and converts it into audio frequency (AF) energy which in turn actuates a loudspeaker to create sound waves. AF energy is in the range of 20 to 20,000 Hz.

*kHz is an abbreviation of kilohertz or 1000 hertz, MHz is abbreviation of megahertz or 1,000,000 hertz, where hertz is a unit of frequency.

OPERATING NOTES

The IC-R20 may receive its own oscillated frequency, resulting in no reception or only noise reception, on some frequencies.

The IC-R20 may receive interference from extremely strong signals on different frequencies or when using an external high-gain antenna.

TABLE OF CONTENTS

FOREWORD	i	■ RF gain	19	■ Tone squelch frequency/DTCS code setting	46
IMPORTANT	i	■ Duplex operation	20	■ DTCS polarity setting	47
EXPLICIT DEFINITIONS	i	■ AFC function	21	■ Tone scan	48
PRECAUTION	ii	■ NB/ANL functions	21	10 SET MODE	49–59
SUPPLIED ACCESSORIES	iii	■ Band scope	22	■ General	49
OPERATING THEORY	iii	■ [DIAL] function assignment	23	■ Set mode items	50
OPERATING NOTES	iii	5 DUALWATCH OPERATION	24–25	11 OTHER FUNCTIONS	60–67
TABLE OF CONTENTS	iv	■ Main band selection	24	■ Antenna selection	60
QUICK REFERENCE GUIDE	I–VIII	■ Band exchange	24	■ Weather channel operation	61
■ Preparations	I	■ Setting audio volume	25	■ Data cloning	62
■ Your first scanning experience	IV	■ Squelch level setting	25	■ Auto power-off function	63
■ Memory programming	VI	6 MEMORY CHANNELS	26–33	■ IC recorder	64
■ Programmed scan operation	VII	■ General description	26	■ Partial reset	67
1 PANEL DESCRIPTION	1–7	■ Memory channel programming	26	■ All reset	68
■ Front, top and side panels	1	■ Memory bank setting	27	12 CONTROL COMMAND	68–69
■ Function display	6	■ Memory bank selection	28	■ General	68
2 BATTERY INSTALLATION/CHARGING ...	8–10	■ Programming memory/bank name	29	■ Data format	68
■ Battery installation	8	■ Selecting memory/bank name indication	30	■ Command table	68
■ Caution	9	■ Copying memory contents	31	13 FREQUENCY TABLE	70–77
■ Battery charging	9	■ Memory clearing	32	■ TV channels	70
3 FREQUENCY AND CHANNEL SETTING	11–16	■ Erasing/transferring bank contents	33	■ VHF marine channels	73
■ Mode selection	11	7 SCAN OPERATION	34–41	■ Weather channels	73
■ Operating band selection	12	■ Scan types	34	■ Other communications in the USA	74
■ Setting a tuning step	14	■ Full/band/programmed scan	35	■ Other communications—other countries	76
■ Setting a frequency	14	■ Scan edges programming	36	14 MAINTENANCE	78
■ Receive mode selection	16	■ Memory/bank/all bank scan	37	■ Troubleshooting	78
■ Lock function	16	■ Auto-memory write scan	38	15 SPECIFICATIONS	79
4 BASIC OPERATION	17–23	■ Skip channel/frequency setting	39	16 OPTIONS	80
■ Receiving	17	■ Scan resume condition	40	17 DRIVER INSTALLATION	81
■ Setting audio volume	17	8 PRIORITY WATCH	42–44	18 POCKET GUIDE	92
■ Squelch level setting	18	■ Priority watch types	42	19 CE	94
■ Monitor function	18	■ Priority watch operation	43		
■ Attenuator function	19	9 COMFORTABLE RECEIVING	45–48		
		■ Tone/DTCS squelch operation	45		

QUICK REFERENCE GUIDE

■ Preparations

◇ Batteries installation

① Remove the battery cover from the receiver.

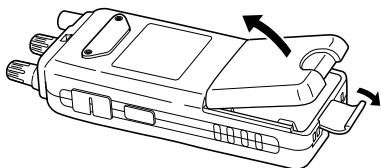

② For alkaline battery use, attach the supplied battery spacer.

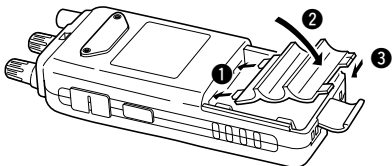

③ Install 3 R6 (AA) size alkaline batteries.

• Be sure to observe the correct polarity.

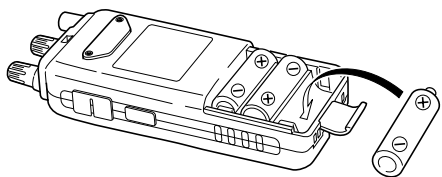

/// Keep the battery contacts clean to avoid rust or poor contact.
/// It's a good idea to clean the battery terminals once a week.

◇ Battery pack installation

① Remove the battery cover from the receiver.

② Remove the supplied battery spacer for R6 (AA) size battery use.

③ Install the Li-Ion battery pack (BP-206).

• Be sure to observe the correct direction.

• Charge Li-Ion battery pack (BP-206) before use. (Refer to p. IV for charging instructions.)

•Battery pack installation

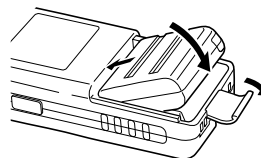

•Battery pack removal

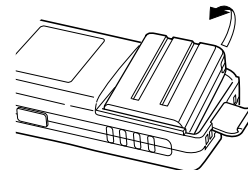

◇ Handstrap

Slide the handstrap through the loop on the top of the rear panel as illustrated at below. Facilitates carrying.

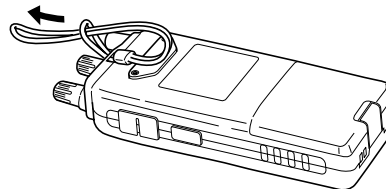

◆ **Belt clip**

Conveniently attaches to your belt.
Attach the belt clip with the supplied screws using a phillips screwdriver.

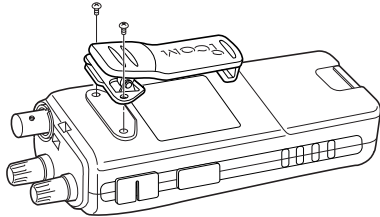

◆ **Swivel belt clip (Option)**

The optional swivel belt clip (MB-86) is useful for easy attaching/detaching the receiver to/from the belt.

① Attach the stopper with the supplied screws using a phillips screwdriver.

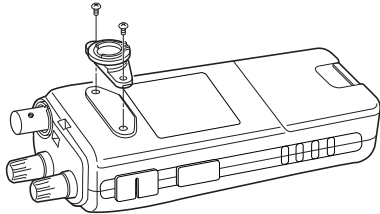

② Clip the belt clip to your belt.

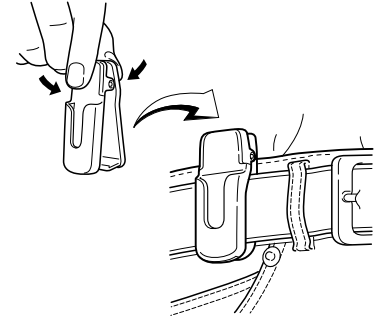

③ Insert the receiver into the end of the clip as shown at right.

- Once the receiver is locked in place, it will swivel 360 degrees.

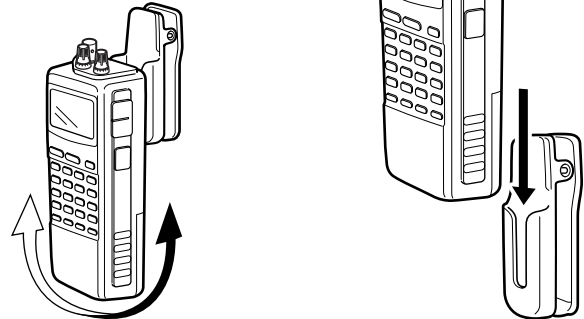

QUICK REFERENCE GUIDE

To remove:

- ④ Turn the receiver upside down, and then lift to release the receiver from the belt clip as shown at upper right.

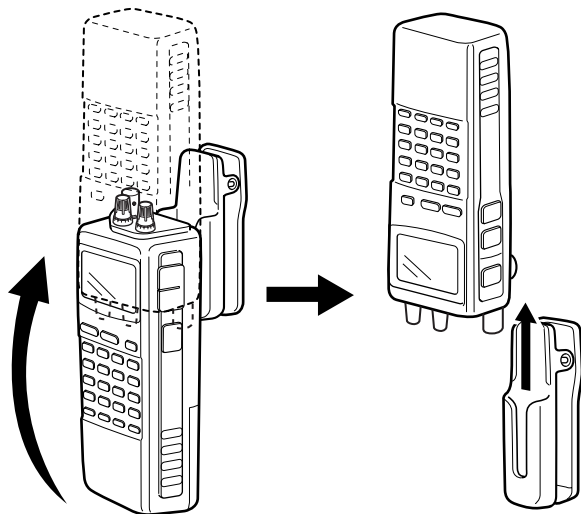

◆ **Antenna**

Insert the supplied antenna into the antenna connector and screw down the antenna as shown at right.

NEVER hold the antenna when carrying the receiver.

/// ✓ **For your information**
Third-party antennas may increase receiver performance.

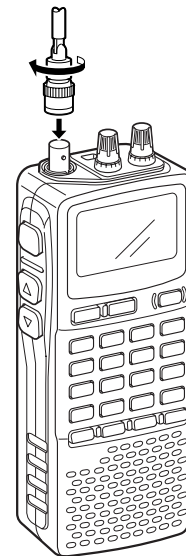

◇ Charging the battery

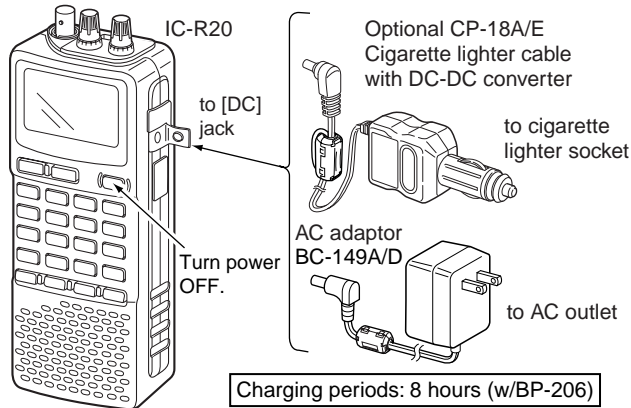

- ① Install the battery pack (BP-206).
- ② Plug the AC adaptor into an AC outlet.
- ③ Turn OFF the receiver, then insert the adaptor plug into the [DC] jack of the receiver.

⚠ WARNING!
NEVER attempt to charge any other batteries. Because the IC-R20 can charge the BP-206 only.

Keep the jack cover attached when jack is not in use to protect the connectors from dust and moisture.

■ Your first scanning experience

Now that you have your IC-R20 ready, you are probably excited to start listening. We would like to take you through a few basic operation steps to make your first “Scanning Experience” enjoyable.

◇ About default setting

The frequency control ([R-DIAL]) function can be traded with volume control ([L-DIAL] and [▲]/[▼] keys) function by pushing for 1 sec. [1 DIAL.SEL]. However, in this QUICK REFERENCE GUIDE, the factory default setting ([R-DIAL] sets operating frequency) is used for simple instruction.

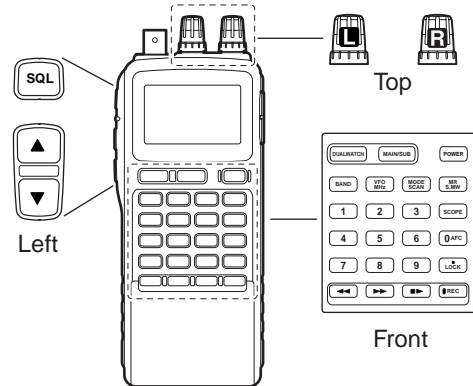

QUICK REFERENCE GUIDE

◇ Basic operation

1. Turning ON the receiver

- ➔ Push **[POWER]** for 1 sec. to turn the power ON.

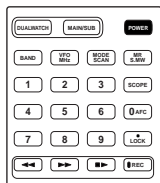

POWER

Front

2. Adjusting audio level

- ➔ Rotate **[L-DIAL]** (or push **[▲]**/**[▼]**) to set the desired audio level.



Left



Top

3. Adjusting squelch level

- ➔ While pushing **[SQL]**, rotate **[R-DIAL]** to set the squelch level.



Left



Top

4. Tune the desired frequency

The tuning dial will allow you to dial in the frequency you want to operate. Pages 9 and 15 will instruct you on how to set the tuning speed.

[Using the tuning dial]

- ① Push **[BAND]** several times to select the desired frequency band.
 - While pushing **[BAND]**, rotate **[R-DIAL]** also select frequency band.



Top

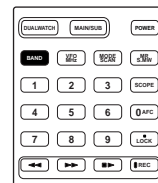

BAND

Front

- ② Rotate **[R-DIAL]** to set the desired receive frequency.
 - Push **[VFO MHz]** for 1 sec. then rotate **[R-DIAL]** to change the frequency in 1 MHz steps, or push for 1 sec. again then rotate **[R-DIAL]** to change the frequency in 10 MHz steps. (Each push for 1 sec. toggles 1 MHz or 10 MHz tuning steps.)



Top

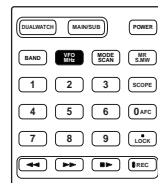

VFO MHz

Front

Count on us!

#02 Europe

#03 U.K.

<Intended Country of Use>			
<input checked="" type="checkbox"/> GER	<input type="checkbox"/> FRA	<input checked="" type="checkbox"/> ESP	<input checked="" type="checkbox"/> SWE
<input checked="" type="checkbox"/> AUT	<input checked="" type="checkbox"/> NED	<input checked="" type="checkbox"/> POR	<input checked="" type="checkbox"/> DEN
<input checked="" type="checkbox"/> GBR	<input checked="" type="checkbox"/> BEL	<input checked="" type="checkbox"/> ITA	<input checked="" type="checkbox"/> FIN
<input checked="" type="checkbox"/> IRL	<input checked="" type="checkbox"/> LUX	<input checked="" type="checkbox"/> GRE	<input type="checkbox"/> SUI
<input type="checkbox"/> NOR			

#07 France

<Intended Country of Use>			
<input type="checkbox"/> GER	<input checked="" type="checkbox"/> FRA	<input type="checkbox"/> ESP	<input type="checkbox"/> SWE
<input type="checkbox"/> AUT	<input type="checkbox"/> NED	<input type="checkbox"/> POR	<input type="checkbox"/> DEN
<input type="checkbox"/> GBR	<input type="checkbox"/> BEL	<input type="checkbox"/> ITA	<input type="checkbox"/> FIN
<input type="checkbox"/> IRL	<input type="checkbox"/> LUX	<input type="checkbox"/> GRE	<input type="checkbox"/> SUI
<input type="checkbox"/> NOR			