



INSTRUCTION MANUAL

VHF/UHF DIGITAL TRANSCEIVER

IC-80AD

This device complies with Part 15 of the FCC Rules. Operation is subject to the following two conditions: (1) this device may not cause harmful interference, and (2) this device must accept any interference received, including interference that may cause undesired operation.

WARNING: MODIFICATION OF THIS DEVICE TO RECEIVE CELLULAR RADIOTELEPHONE SERVICE SIGNALS IS PROHIBITED UNDER FCC RULES AND FEDERAL LAW.

Icom Inc.





FOREWORD

Thank you for purchasing this fine Icom product. We understand you have a choice of many different radios in the market place. Many hours of research and development went into the design of your IC-80AD, following Icom's philosophy of "technology first."

The IC-80AD VHF/UHF DIGITAL TRANSCEIVER is designed with Icom's superior technology and craftsmanship combining traditional analog technologies with the new digital technology, Digital Smart Technologies for Amateur Radio (D-STAR), for a balanced package.

With proper care, this product should provide you with years of trouble-free operation. We want to take a couple of moments of your time to thank you for making your IC-80AD your radio of choice, and hope you agree with Icom's philosophy of "technology first."

EXPLICIT DEFINITIONS

WORD	DEFINITION
 DANGER!	Personal death, serious injury or an explosion may occur.
 WARNING!	Personal injury, fire hazard or electric shock may occur.
CAUTION	Equipment damage may occur.
NOTE	Recommended for optimum use. No risk of personal injury, fire or electric shock.

FEATURES

- *DV mode (Digital voice + Low-speed data communication) operation-ready*
 - *Text message and call sign exchange*
 - *Transmitting position data with a GPS receiver*
- *GPS receiver connectable*
 - *Optional HM-189GPS is required*
- *DR (D-STAR Repeater) mode and repeater list allow you to operate a D-STAR repeater simply*
- *Splash-resistant construction (IPX4*)*
 - *Only when the supplied battery pack (or optional battery case), antenna and jack cover are attached.

IMPORTANT

READ ALL INSTRUCTIONS carefully and completely before using the transceiver.

SAVE THIS INSTRUCTION MANUAL— This instruction manual contains important operating instructions for the IC-80AD.

PRECAUTIONS

⚠ WARNING RF EXPOSURE! This device emits Radio Frequency (RF) energy. Caution should be observed when operating this device. If you have any questions regarding RF exposure and safety standards please refer to the Federal Communications Commission Office of Engineering and Technology's report on Evaluating Compliance with FCC Guidelines for Human Radio Frequency Electromagnetic Fields (OET Bulletin 65)

⚠ WARNING! NEVER hold the transceiver so that the antenna is very close to, or touching exposed parts of the body, especially the face or eyes, while transmitting. The transceiver will perform best if the microphone is 5 to 10 cm (2 to 4 inches) away from the lips and the transceiver is vertical.

⚠ WARNING! NEVER operate the transceiver with an earphone, headphones or other audio accessories at high volume levels. Hearing experts advise against continuous high volume operation. If you experience a ringing in your ears, reduce the volume level or discontinue use.

⚠ WARNING! NEVER operate the transceiver while driving a vehicle. Safe driving requires your full attention—anything less may result in an accident.

NEVER connect the transceiver to a power source of more than 16 V DC. This will ruin the transceiver.

NEVER connect the transceiver to a power source using reverse polarity. This will ruin the transceiver.

DO NOT operate the transceiver near unshielded electrical blasting caps or in an explosive atmosphere.

DO NOT push the PTT unless you actually intend to transmit.

BE CAREFUL! The transceiver will become hot when operating it continuously for long periods.

DO NOT use or place the transceiver in direct sunlight or in areas with temperatures below -20°C (-4°F) or above $+60^{\circ}\text{C}$ ($+140^{\circ}\text{F}$).

Place the unit in a secure place to avoid inadvertent use by children.

DO NOT use harsh solvents such as benzene or alcohol to clean the transceiver, because they can damage the transceiver's surfaces.

PRECAUTIONS

KEEP away from heavy rain, and never immerse the IC-80AD in the water. The transceiver meets IPX4* requirements for splash resistance. However, once the transceiver has been dropped, splash resistance cannot be guaranteed because of possible damage to the transceiver's case or waterproof seal.

*Only when the supplied battery pack (or optional battery case), antenna and jack cover are attached.

NEVER operate or touch the transceiver with wet hands. This may result in an electric shock or may damage the transceiver.

Even when the transceiver power is OFF, a slight current still flows in the circuits. Remove the battery pack or batteries from the transceiver when not using it for a long time. Otherwise, the installed battery pack or batteries will become exhausted, and will need to be recharged or replaced.

• Important notes when using GPS receiver

Please do not use the HM-189GPS close to the transceiver's antenna. The transmit signal may cause GPS receiver malfunction.

FCC INFORMATION

• FOR CLASS B UNINTENTIONAL RADIATORS:

This equipment has been tested and found to comply with the limits for a Class B digital device, pursuant to part 15 of the FCC Rules. These limits are designed to provide reasonable protection against harmful interference in a residential installation. This equipment generates, uses and can radiate radio frequency energy and, if not installed and used in accordance with the instructions, may cause harmful interference to radio communications. However, there is no guarantee that interference will not occur in a particular installation. If this equipment does cause harmful interference to radio or television reception, which can be determined by turning the equipment off and on, the user is encouraged to try to correct the interference by one or more of the following measures:

- Reorient or relocate the receiving antenna.
- Increase the separation between the equipment and receiver.
- Connect the equipment into an outlet on a circuit different from that to which the receiver is connected.
- Consult the dealer or an experienced radio/TV technician for help.

For U.S.A. only

CAUTION: Changes or modifications to this device, not expressly approved by Icom Inc., could void your authority to operate this device under FCC regulations.

SUPPLIED ACCESSORIES

The following accessories are supplied with the transceiver.

- ① Hand strap 1
- ② Antenna 1
- ③ Battery pack (BP-217) 1
- ④ Belt clip 1
- ⑤ Battery charger (BC-167SA/SC/SV)* 1

* The BC-167SA, BC-167SC and BC-167SV have different shapes.

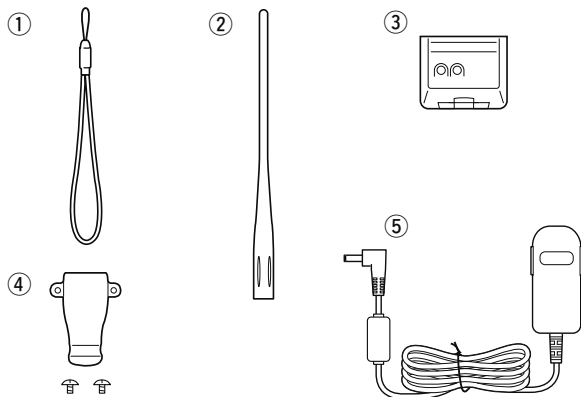

Icom, Icom Inc. and the Icom logo are registered trademarks of Icom Incorporated (Japan) in the United States, the United Kingdom, Germany, France, Spain, Russia and/or other countries.

Microsoft, Windows and Windows Vista are registered trademarks of Microsoft Corporation in the United States and/or other countries.

TABLE OF CONTENTS

FOREWORD	i
EXPLICIT DEFINITIONS	i
FEATURES	i
IMPORTANT	i
PRECAUTIONS	ii, iii
FCC INFORMATION	iii
SUPPLIED ACCESSORIES	iv
TABLE OF CONTENTS	v–vii

1 ACCESSORY ATTACHMENT 1–2

■ Antenna	1
■ Belt clip	1
■ Hand strap	2
■ Battery pack	2

2 PANEL DESCRIPTION 3–9

■ Front, top and side panels	3
■ Function display	8

3 BATTERY CHARGING 10–15

■ Caution	10
■ Regular charging	12
■ Rapid charging	13
■ Optional battery case	14
■ Battery information	14
■ External DC power operation	15

4 BASIC OPERATION 16–28

■ Power ON	16
■ Setting audio volume	16

■ Setting squelch level	17
■ Monitor function	17
■ Mode selection	18
■ [DIAL] function assignment	20
■ Operating band selection	20
■ Setting a tuning step	22
■ Setting a frequency	22
■ Lock function	24
■ Receiving	24
■ Operating mode selection	25
■ Attenuator function	25
■ Transmitting	26
■ Transmit power selection	27
■ TV channel operation	27

5 REPEATER AND DUPLEX OPERATIONS 29–33

■ Repeater operation	29
■ Duplex operation	31
■ Auto repeater function	32
■ 1750 Hz tone	33

6 DV MODE PROGRAMMING 34–46

■ About the D-STAR system	34
■ Call sign programming	36
■ Repeater list	39
■ Repeater list programming	40
■ Changing a repeater list	45
■ Clearing a repeater list	46

TABLE OF CONTENTS

7 DV MODE OPERATION	47–76
■ Digital mode operation	47
■ Current call sign setting	47
■ Receiving a D-STAR repeater	48
■ Received call sign	49
■ Copying the call sign	51
■ DR (D-STAR Repeater) mode operation	53
■ Calling CQ	54
■ Calling a specific station	56
■ Simplex operation in VFO	60
■ Repeater operation in VFO	62
■ Message operation	68
■ Automatic reply function	70
■ EMR communication	71
■ Break-in communication	72
■ Low-speed data communication	74
■ Other function for DV mode operation	76
8 GPS/GPS-A OPERATION	77–90
■ GPS operation	77
■ GPS-A operation	90
9 MEMORY/CALL CHANNELS	91–101
■ General description	91
■ Selecting a memory channel	92
■ Selecting a call channel	93
■ Memory channel programming	94
■ Memory bank setting	95
■ Memory bank selection	96
■ Programming memory/bank/scan name	97

■ Selecting memory/bank name indication	98
■ Copying memory/call contents	99
■ Memory clearing	100
■ Erasing/transferring bank contents	101
10 SCAN OPERATION	102–110
■ Scan types	102
■ Full/band/programmed scan	104
■ Scan edges programming	105
■ Memory scan	106
■ Memory bank scan	107
■ Skip channel/frequency setting	108
■ Scan resume condition	110
11 PRIORITY WATCH	111–114
■ Priority watch types	111
■ Priority watch operation	112
12 MENU SCREEN OPERATION	115–142
■ General	115
■ MENU screen indication and arrangement	116
■ Items list	117
■ DUP/TONE items (DUPT)	119
■ Scan items (SCAN)	121
■ Set mode items (SET)	124
□ Function set mode items (FUNC)	124
□ Display set mode items (DISP)	129
□ Sounds set mode items (SOUNDS)	130
■ DV set mode items (DV SET)	132
■ GPS mode items (GPS)	136

1
2
3
4
5
6
7
8
9
10
11
12
13
14
15
16

TABLE OF CONTENTS

13 OTHER FUNCTIONS 143–159

- Programming a DTMF code 143
- Transmitting a DTMF code..... 144
- Clearing a DTMF memory 145
- Confirming a DTMF memory 146
- Setting DTMF transfer speed..... 146
- Tone frequency and DTCS code..... 147
- Digital code and digital call sign setting 148
- Tone/DTCS squelch 150
- Digital squelch 151
- Pocket beep function 151
- DTCS polarity setting..... 152
- Tone scan..... 152
- Beep tones..... 153
- Dial speed acceleration 153
- Key lock effect..... 154
- Weather channel operation..... 154
- Power save 156
- Auto power OFF..... 156
- Auto power ON 156
- Time-out timer..... 157
- PTT lock..... 157
- Display backlighting 157
- LCD contrast..... 157
- Cloning function..... 158
- Resetting..... 159

14 TROUBLESHOOTING..... 160

15 SPECIFICATIONS..... 161–162

16 OPTIONS 163–166

- Optional HM-75A REMOTE CONTROL SPEAKER MICROPHONE 164
- Optional HM-189GPS GPS SPEAKER MICROPHONE 166

INDEX 167–173

ACCESSORY ATTACHMENT

1

■ Antenna

Insert the supplied antenna into the antenna connector and screw down the antenna as shown below.

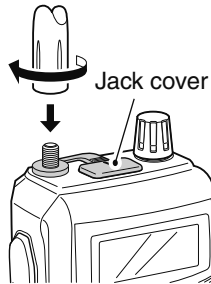

NEVER carry the transceiver by holding the antenna.

KEEP the jack cover attached when jack is not in use to protect the connector from dust and moisture.

✓ **For your information**

Third-party antennas may increase transceiver performance. An optional AD-92SMA ANTENNA CONNECTOR ADAPTER is available to connect an antenna that has a BNC connector.

■ Belt clip

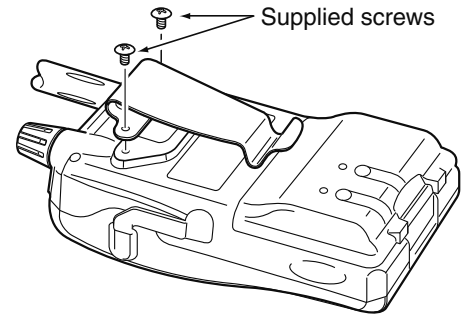

CAUTION:

USE the supplied screws only. Using screws longer than specified could damage the transceiver.

1 ACCESSORY ATTACHMENT

■ Hand strap

To facilitate carrying the transceiver, slide the hand strap through the loop on the top of the belt clip as illustrated below.

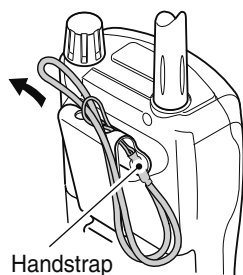

■ Battery pack

Attach the Li-Ion battery pack (BP-217) or battery case (BP-216) as illustrated below.

- Charge the Li-Ion battery pack before use. (pgs. 12, 13)

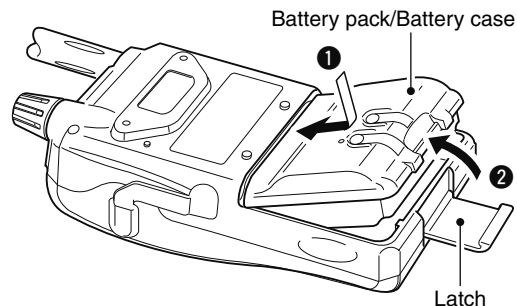

■ Front, top and side panels

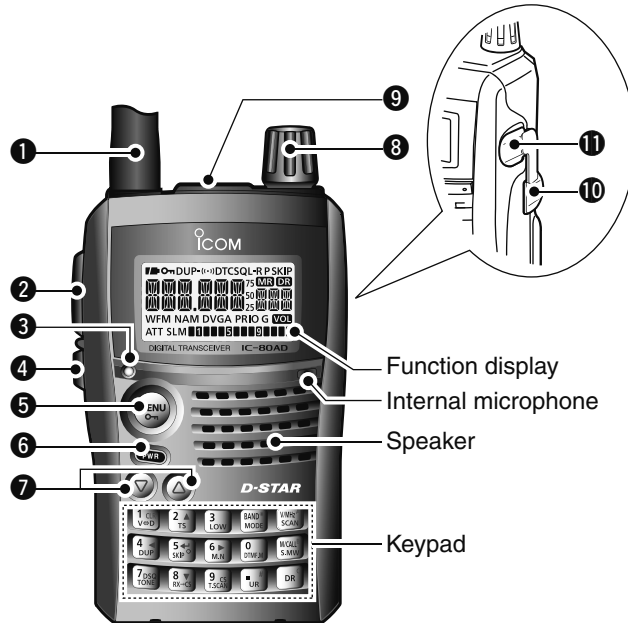

❶ ANTENNA CONNECTOR (p. 1)

Connects the supplied antenna.

- An optional AD-92SMA adapter (p. 163) is available for connecting an antenna with a BNC connector.

❷ PTT SWITCH [PTT] (p. 26)

Push and hold to transmit, release to receive.

❸ TX/RX INDICATOR [TX/RX] (pgs. 24, 26)

Lights green while receiving a signal or when the squelch is open; lights red while transmitting.

❹ SQUELCH KEY [SQL] (p. 17)

- Push and hold to open the squelch temporarily and monitor the operating frequency.
- While pushing and holding this key, rotate [DIAL] to adjust the squelch level.

❺ MENU • LOCK KEY [MENU

- Push to enter menu screen indication ON and OFF. (p. 115)
 - Pushing [V/MHz] also exits from menu screen.
- Push and hold for 1 sec. to toggle the lock function ON and OFF. (p. 24)

❻ POWER KEY [PWR]

Push and hold for 1 sec. to turn the transceiver power ON and OFF. (p. 16)

2 PANEL DESCRIPTION



⑦ VOLUME CONTROL KEY [Δ]/ ∇]

- ➔ Adjust audio volume level. (p. 16)
- ➔ [Δ] enters or sends the DTMF code 'D.' (pgs. 143–145)

/// The function of tuning control and volume control can be traded. See page 20 for details.

⑧ CONTROL DIAL [DIAL]

- ➔ Rotate to tune the operating frequency. (p. 22)
- ➔ During memory mode, rotate to select the memory channel. (pgs. 18, 92)
- ➔ While scanning, changes the scanning direction. (pgs. 53, 104, 106, 107)
- ➔ While pushing and holding [SQL], sets the squelch level. (p. 17)
- ➔ After pushing [BAND] during memory mode operation, selects the programmed bank. (p. 96)
- ➔ During menu screen operation, rotate to select the set items or values. (p. 115)

/// The function of tuning control and volume control can be traded. See page 20 for details.

⑨ EXTERNAL SPEAKER/MICROPHONE JACK [SP/MIC]

Connect a cloning cable, optional speaker microphone or headset, if desired.

See page 163 for a list of available options.

/// Be sure to turn power OFF before connecting/disconnecting optional equipment to/from the [SP/MIC] jack.

Count on us!

A-6700D-1EX-0a
Printed in Japan
© 2009–2010 Icom Inc.
Printed on recycled paper with soy ink.

Icom Inc.
1-1-32 Kamiminami, Hirano-ku, Osaka 547-0003, Japan