



INSTRUCTION MANUAL

144 MHz FM TRANSCEIVER **IC-2100H**

This device complies with Part 15 of the FCC rules. Operation is subject to the following two conditions: (1) This device may not cause harmful interference, and (2) this device must accept any interference received, including interference that may cause undesired operation.

Icom Inc.

FOREWORD

Thank you for purchasing this Icom product. The IC-2100H/-T 144 MHz FM TRANSCEIVER is designed and built with Icom's superior technology and craftsmanship. With proper care this product should provide you with years of trouble-free operation.

IMPORTANT

READ ALL INSTRUCTIONS carefully and completely before using the transceiver.

SAVE THIS INSTRUCTION MANUAL—This instruction manual contains important operating instructions for the IC-2100H/-T.

EXPLICIT DEFINITIONS

WORD	DEFINITION
⚠ WARNING	Personal injury, fire hazard or electric shock may occur.
CAUTION	Equipment damage may occur.
NOTE	If disregarded, inconvenience only. No risk of personal injury, fire or electric shock.

CAUTIONS

⚠ WARNING! NEVER connect the transceiver to an AC outlet. This may pose a fire hazard or result in an electric shock.

⚠ WARNING! NEVER operate the transceiver while driving a vehicle. Safe driving requires your full attention—anything less may result in an accident.

NEVER connect the transceiver to a power source of more than 16 V DC. This will ruin the transceiver.

NEVER connect the transceiver to a power source using reverse polarity. This will ruin the transceiver.

NEVER cut the DC power cable between the DC plug and fuse holder. If an incorrect connection is made after cutting, the transceiver may be damaged.

NEVER place the transceiver where normal operation of the vehicle may be hindered or where it could cause bodily injury.

NEVER let objects impede the operation of the cooling fan on the rear panel.

DO NOT push the PTT when not actually desiring to transmit.

DO NOT allow children to play with any radio equipment containing a transmitter.

SUPPLIED ACCESSORIES

During mobile operation, **DO NOT** operate the transceiver without running the vehicle's engine. When transceiver power is ON and your vehicle's engine is OFF, the vehicle's battery will soon become exhausted.

BE CAREFUL! The transceiver will become hot when operating it continuously for long periods.

AVOID using or placing the transceiver in direct sunlight or in areas with temperatures below -10°C ($+14^{\circ}\text{F}$) or above $+60^{\circ}\text{C}$ ($+140^{\circ}\text{F}$).

AVOID the use of chemical agents such as benzine or alcohol when cleaning, as they can damage the transceiver's surfaces.

USE Icom microphones only (supplied or optional). Other manufacturer's microphones have different pin assignments and may damage the transceiver if attached.

For U.S.A. only

Caution: Changes or modifications to this transceiver, not expressly approved by Icom Inc., could void your authority to operate this transceiver under FCC regulations.

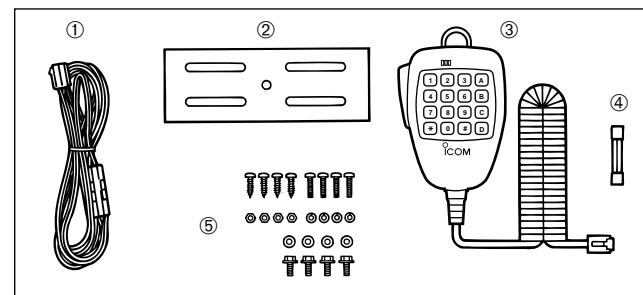

- ① DC power cable 1
- ② Mobile mounting bracket 1
- ③ Microphone (HM-118T*) 1
- ④ Fuse (20 A) 1
- ⑤ Mounting screws, nuts and washers 1 set
- ⑥ Mic hanger (depending on version) 1

*The microphone illustrated above is the HM-118T.

- HM-97 Europe versions
- HM-98S USA, Taiwan versions
- HM-118 Asia, Australia versions
- HM-118T Thailand, Latin America, Korea versions
- HM-118TA some USA versions

TABLE OF CONTENTS

FOREWORD	ii	4 BASIC OPERATION	17–19
IMPORTANT	ii	■ Receiving	17
EXPLICIT DEFINITIONS	ii	■ Monitor function	17
CAUTIONS	ii	■ Audio mute function	17
SUPPLIED ACCESSORIES	iii	■ Transmitting	18
TABLE OF CONTENTS	iv	■ Selecting output power	18
		■ One-touch PTT function	19
1 PANEL DESCRIPTION	1–8	5 REPEATER OPERATION	20–24
■ Front panel	1	■ Accessing a repeater	20
■ Function display	3	■ Subaudible tones	22
■ Rear panel	5	■ Offset frequency	23
■ Microphone	6	■ Auto repeater	24
■ Microphone keypad	7	■ Repeater lockout	24
2 INSTALLATION	9–11	6 MEMORY OPERATION	25–30
■ Location	9	■ General description	25
■ Using the mounting bracket	9	■ Memory channel selection	25
■ Battery connection	10	■ Programming a memory channel	26
■ DC power supply connection	10	■ Programming a memory channel via the microphone	27
■ Antenna installation	11	■ Transferring memory contents	28
3 SETTING A FREQUENCY	12–16	■ Clearing a memory	29
■ Preparation	12	■ Alphanumeric display	30
■ Lock functions	13	7 CALL CHANNEL OPERATION	32–33
■ Using the tuning dial	14	■ Calling up the call channel	32
■ Using the [▲]/[▼] keys	14	■ Transferring call channel contents	32
■ Tuning step selection	15	■ Programming the call channel	33
■ Using the keypad	16		

8 SCRATCH PAD MEMORY 34–35

- What is scratch pad memory? 34
- Calling up a scratch pad memory 34
- Transferring scratch pad memory contents 35

9 SCAN OPERATION 36–41

- Scan types 36
- Scan start/stop 37
- Programming scan edges 38
- Programming scan edges via the microphone 39
- Skip channel setting 40
- Scan resume condition 41

10 PRIORITY WATCH 42–43

- Priority watch types 42
- Priority watch operation 43

11 DTMF MEMORY ENCODER 44–45

- Programming a DTMF code 44
- Transmitting a DTMF code 45
- DTMF speed 45

12 POCKET BEEP AND TONE SQUELCH 46–48

- Pocket beep operation 46
- Tone operation 47
- Tone scan 48

13 WIRELESS OPERATION 49–54

- Connection 49

■ HM-90 WIRELESS MICROPHONE 49

- EX-1759 installation 50
- HM-90 switches 51
- Microphone address 54

14 OTHER FUNCTIONS 55–59

- Beep tones ON/OFF 55
- Time-out timer 55
- Auto power-off 56
- Squelch delay 56
- Microphone [F-1]/[F-2] keys 57
- Demonstration display 57
- Display color 58
- Display dimmer 58
- FM narrow mode 58
- Data cloning 59

15 MAINTENANCE 60–62

- Troubleshooting 60
- Fuse replacement 62
- Partial CPU resetting 62
- Resetting the CPU 62

16 SPECIFICATIONS 63

17 OPTIONS 64–65

18 MODE ARRANGEMENT 66–67

■ Front panel

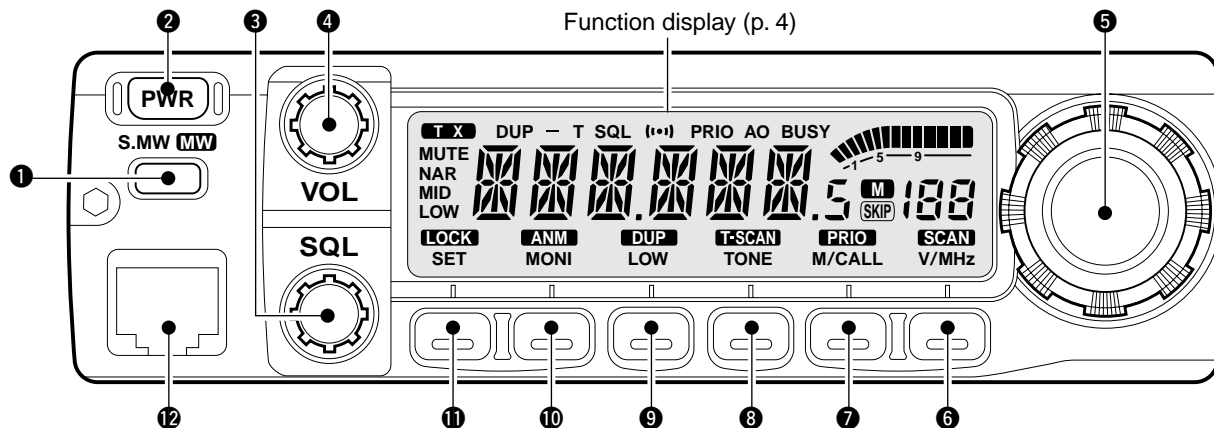

① SELECT MEMORY/MEMORY WRITE SWITCH [S.MW(MW)]

- ➔ Selects a memory channel for programming. (p. 26)
- ➔ Programs selected memory when pushed and held. (p. 27)

② POWER SWITCH [PWR]

Turns power ON and OFF when pushed momentarily.

③ SQUELCH CONTROL [SQL]

Varies the squelch level. (p. 18)

- The RF attenuator activates and increases the attenuation when rotated clockwise to the center position and further.

④ VOLUME CONTROL [VOL]

Adjusts the audio level. (p. 18)

⑤ TUNING DIAL

Selects the operating frequency (p. 15), the memory channel (p. 26), the contents of the set mode display and the scanning direction (p. 37).

⑥ VFO/MHz SWITCH [V/MHz(SCAN)]

- ➔ Selects and toggles VFO mode and the 1 MHz/10 MHz/TS tuning display. (p. 15)
- ➔ Starts a scan when pushed and held for 1 sec. (p. 37)

⑦ MEMORY/CALL CHANNEL SWITCH [M/CALL(PRIO)]

- ➔ Selects and toggles memory mode or the call channel. (pgs. 26, 32)
- ➔ Activates the priority watch function when pushed and held. (p. 42)

⑧ TONE/TONE SCAN SWITCH [TONE(T-SCAN)]

- ➔ Each push selects a tone function. (p. 46)
 - Tone encoder, pocket beep, tone squelch or tone function OFF can be selected.
- ➔ Push and hold to start/stop the tone scan function. (p. 48)

⑨ OUTPUT POWER/DUPLEX SWITCH [LOW(DUP)]

- ➔ Each push changes the output power selection. (p. 19)
 - There are 3 output powers available: low, mid and high (the IC-2100-T Thailand and IC-2100H Taiwan versions have only 2 output powers).
- ➔ Push and hold to select a duplex setting. (p. 21)
 - There are 3 duplex settings available: minus duplex ("DUP—" appears), plus duplex ("DUP" appears) and simplex (no indicator appears).

⑩ MONITOR/ALPHANUMERIC SWITCH [MONI(ANM)]

- ➔ Toggles squelch opened and closed when pushed. (p. 18)
- ➔ In memory and call channel mode, toggles the alphanumeric channel indication ON and OFF. (p. 31)

⑪ SET/LOCK SWITCH [SET(LOCK)]

- ➔ Selects set mode when pushed.
- ➔ Toggles the lock function ON and OFF when pushed and held. (p. 14)

⑫ MICROPHONE CONNECTOR

Connects the supplied microphone. (p. 7)

◇ Microphone connector (front panel view)

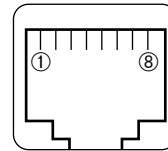

- ① +8 V DC output
- ② Frequency up/down
- ③ NC (no connection)
- ④ PTT
- ⑤ GND (microphone ground)
- ⑥ MIC (microphone input)
- ⑦ GND
- ⑧ NC (no connection)

1 PANEL DESCRIPTION

■ Function display

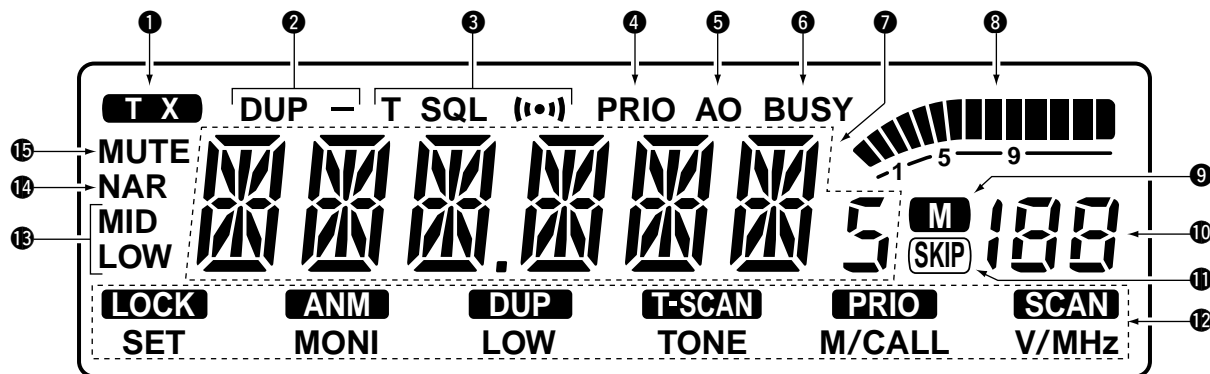

① TRANSMIT INDICATOR

- Appears while transmitting. (p. 19)
- Flashes while transmitting with the one-touch PTT function. (p.20)

② DUPLEX INDICATORS (p. 21)

- “DUP-” or “DUP” appears during semi-duplex operation (repeater operation).

③ TONE INDICATORS

- “T” appears while the subaudible tone encoder is in use. (p. 21)
- “T SQL” appears while the tone squelch function is in use. (p.47)
- “T SQL ((.))” appears while the pocket beep function is

in use. (p. 46)

④ PRIORITY WATCH INDICATOR (p. 42)

- Appears while the priority watch is activated; flashes while the watch is paused.

⑤ AUTO POWER-OFF INDICATOR (p. 56)

- Appears while the auto power-off function is in use.

⑥ BUSY INDICATOR (p. 18)

- Appears when a signal is being received or the squelch is open ([MONI] is pushed).

⑦ FREQUENCY READOUT

- Shows the operating frequency, alphanumeric names, set mode contents, etc.

- Frequency decimal point flashes while scanning. (p. 37)

Count on us!

A-5492H-1EX-④
Printed in Japan
Copyright 1997 Icom Inc.

Icom Inc.
1-1-32 Kamiminami, Hirano-ku, Osaka 547-0003 Japan