



INSTRUCTION MANUAL

VHF/UHF DUAL BAND FM TRANSCEIVER

IC-P7A

This device complies with Part 15 of the FCC rules. Operation is subject to the following two conditions: (1) This device may not cause harmful interference, and (2) this device must accept any interference received, including interference that may cause undesired operation.

WARNING: MODIFICATION OF THIS DEVICE TO RECEIVE CELLULAR RADIO TELEPHONE SERVICE SIGNALS IS PROHIBITED UNDER FCC RULES AND FEDERAL LAW.

Icom Inc.



FOREWORD

Thank you for purchasing this Icom product. The IC-P7A VHF/UHF DUALBAND FM TRANSCEIVER is designed and built with Icom's superior technology and craftsmanship. With proper care, this product should provide you with years of trouble-free operation.

We want to take a couple of moments of your time to thank you for making your IC-P7A your radio of choice, and hope you agree with Icom's philosophy of "technology first." Many hours of research and development went into the design of your IC-P7A.

◆ FEATURES

- *Covers the 0.495–999.990 MHz* frequency range*
*Some frequency bands are disabled according to version
- *CTCSS and DTCS encoder/decoder standard*
- *1250 memory channels* with 18 banks available*
*200 auto write and 50 scan edge channels are included.
- *1800 mAh large capacity Li-Ion battery standard*

IMPORTANT

READ ALL INSTRUCTIONS carefully and completely before using the transceiver.

SAVE THIS INSTRUCTION MANUAL— This instruction manual contains important operating instructions for the IC-P7A.

EXPLICIT DEFINITIONS

WORD	DEFINITION
⚠ DANGER!	Personal death, serious injury or an explosion may occur.
⚠ WARNING!	Personal injury, fire hazard or electric shock may occur.
CAUTION	Equipment damage may occur.
NOTE	If disregarded, inconvenience only. No risk of personal injury, fire or electric shock.

Icom, Icom Inc. and Icom logo are registered trademarks of Icom Incorporated (Japan) in Japan, the United States, the United Kingdom, Germany, France, Spain, Russia, Australia, New Zealand, and/or other countries.

PRECAUTIONS

⚠ **DANGER! NEVER** short the terminals of the transceiver or battery pack.

⚠ **DANGER!** Use and charge only specified Icom battery packs with Icom radios or Icom chargers. Only Icom battery packs are tested and approved for use with Icom radios or charged with Icom chargers. Using third-party or counterfeit battery packs or chargers may cause smoke, fire, or cause the battery to burst.

⚠ **WARNING RF EXPOSURE!** This device emits Radio Frequency (RF) energy. Caution should be observed when operating this device. If you have any questions regarding RF exposure and safety standards please refer to the Federal Communications Commission Office of Engineering and Technology's report on Evaluating Compliance with FCC Guidelines for Human Radio Frequency Electromagnetic Fields (OET Bulletin 65)

⚠ **WARNING! NEVER** hold the transceiver so that the antenna is very close to, or touching exposed parts of the body, especially the face or eyes, while transmitting. The transceiver will perform best if the microphone is 5 to 10 cm (2 to 4 inches) away from the lips and the transceiver is vertical.

⚠ **WARNING! NEVER** operate the transceiver with a headset or other audio accessories at high volume levels. The continuous high volume operation may cause a ringing in your ears. If you experience the ringing, reduce the volume level or discontinue use.

⚠ **WARNING! NEVER** operate the transceiver while driving a vehicle. Safe driving requires your full attention—anything less may result in an accident.

⚠ **WARNING! NEVER** operate or touch the transceiver with wet hands. This may result in an electric shock or may damage the transceiver.

DO NOT expose the transceiver to rain, snow or any liquids. The transceiver may be damaged.

DO NOT operate or touch the transceiver with wet hands. This may result in an electric shock or damage the transceiver.

DO NOT push the PTT when not actually desiring to transmit.

DO NOT operate or place the transceiver in direct sunlight or in areas with temperatures below -10°C ($+14^{\circ}\text{F}$) or above $+60^{\circ}\text{C}$ ($+140^{\circ}\text{F}$).

DO NOT use harsh solvents such as benzine or alcohol when cleaning, as they will damage the radio surfaces.

Place the unit in a secure place to avoid inadvertent use by children.

For U.S.A. only

CAUTION: Changes or modifications to this device, not expressly approved by Icom Inc., could void your authority to operate this device under FCC regulations.

SUPPLIED ACCESSORIES

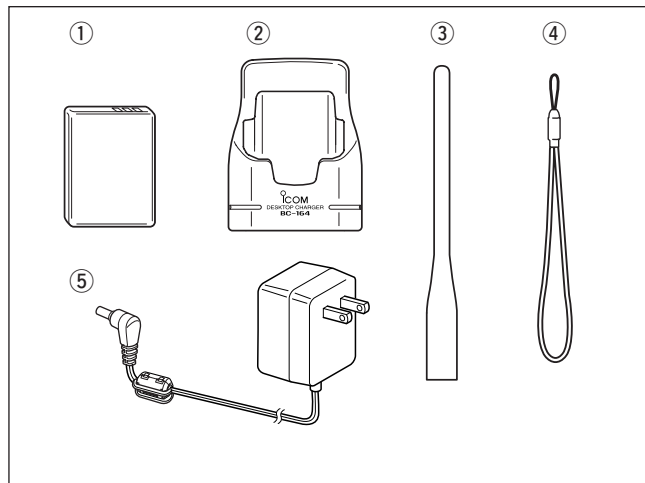

- ① Battery pack (BP-243) 1
 - ② Battery charger (BC-164) 1
 - ③ Antenna 1
 - ④ Handstrap 1
 - ⑤ AC adapter* (BC-145LA/LE/LV) 1
- (The shape of the BC-145LA, BC-145LE and BC-145LV are different.)

*Depending on versions. Not supplied with some versions.

TABLE OF CONTENTS

FOREWORD	i
IMPORTANT	i
EXPLICIT DEFINITIONS	i
PRECAUTION	ii
SUPPLIED ACCESSORIES	iii
TABLE OF CONTENTS	iii
QUICK REFERENCE GUIDE	I-VIII
■ Preparation.....	I
■ Your first contact.....	III
■ Repeater operation	V
■ Memory programming.....	VI
■ Programmed scan operation.....	VII
1 PANEL DESCRIPTION	1-4
■ Front, top and side panels	1
■ Function display	3
2 BATTERY CHARGING	5-8
■ Caution	5
■ Battery installation	7
■ Battery charging	8
3 FREQUENCY AND CHANNEL SETTING	9-12
■ VFO and memory channels.....	9
■ Operating band selection	9
■ Setting a frequency.....	11
■ Setting a tuning step.....	11
■ Selecting a memory channel	12
■ Selecting a call channel.....	12
4 BASIC OPERATION	13-18
■ Receiving.....	13
■ Setting audio volume.....	13
■ Squelch level setting	14
■ Operating mode selection	14
■ Monitor function.....	15
■ Attenuator function	15

■ Transmitting.....	16
■ Transmit power selection	16
■ Dial select step	17
■ Lock function	18
■ [DIAL] function assignment	18
5 REPEATER OPERATION.....	19–23
■ General.....	19
■ Offset frequency	20
■ Subaudible tones.....	21
■ 1750 Hz tone	22
■ Auto repeater function.....	23
6 MEMORY/CALL CHANNELS	24–33
■ General description	24
■ Memory channel programming.....	24
■ Memory bank setting.....	25
■ Memory bank selection	26
■ Programming memory/bank name	27
■ Selecting display type.....	28
■ Copying memory contents.....	29
■ Memory clearing	30
■ Transferring memory contents	31
■ Erasing/transferring bank contents.....	32
■ Call channel programming	33
■ Copying call channel contents.....	33
7 SCAN OPERATION	34–41
■ Scan types.....	34
■ Full/band/programmed scan.....	35
■ Scan edges programming	36
■ Memory/bank scan	37
■ Auto memory write scan.....	38
■ Skip channel/frequency setting	39
■ Scan resume condition.....	41
8 PRIORITY WATCH	42–44

■ Priority watch types	42
■ Priority watch operation.....	43
9 TONE SQUELCH AND POCKET BEEP	45–48
■ Tone/DTCS squelch operation	45
■ Tone squelch frequency/DTCS code setting	46
■ DTCS polarity setting	47
■ Tone scan	48
10 SET MODE	49–59
■ General.....	49
■ Set mode items	50
11 OTHER FUNCTIONS	60–64
■ Weather channel operation	60
■ Data cloning	61
■ Auto power-off function	63
■ TV channel operation	63
■ Partial reset	64
■ All reset	64
12 FREQUENCY TABLE	65–72
■ TV channels	65
■ VHF marine channels.....	68
■ Weather channels	68
■ Other communications in the USA	69
■ Other communications—other countries.....	71
13 MAINTENANCE	73–74
■ Troubleshooting.....	73
■ Optional CP-21LR fuse replacement.....	74
14 SPECIFICATIONS	75–76
■ Transceiver.....	75
■ Battery pack (BP-243)	76
■ Battery charger (BC-164)	76
15 OPTIONS	77–79
■ Options	77
16 POCKET GUIDE	80–81

QUICK REFERENCE GUIDE

■ Preparation

◇ Battery installation

- ① Remove the battery cover from the transceiver.
- ② Install the BP-243 (Li-Ion battery pack).
 - Be sure to observe the correct polarity.
- ③ Replace the battery cover to the transceiver.

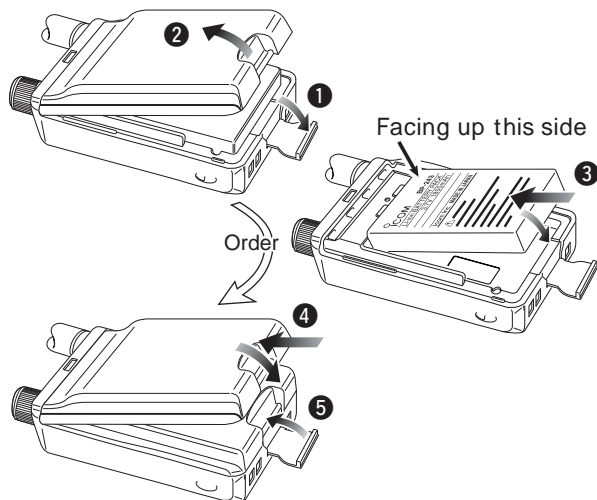

Keep the battery contacts clean. It's a good idea to clean the battery terminals once a week.

◇ Antenna

Insert the supplied antenna into the antenna connector and screw down the antenna as shown at right.

NEVER hold the antenna when carrying the transceiver.

Keep the jack cover attached when jack is not in use to protect the connector from dust and moisture.

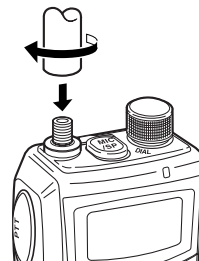

✓ For your information

Third-party antennas may increase transceiver performance. An optional AD-92SMA ANTENNA CONNECTOR ADAPTER is available to connect an antenna with a BNC connector.

◇ Handstrap

Slide the handstrap through the loop on the top of the rear panel as illustrated at right. Facilities carrying.

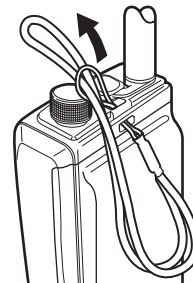

◇ Charging the battery

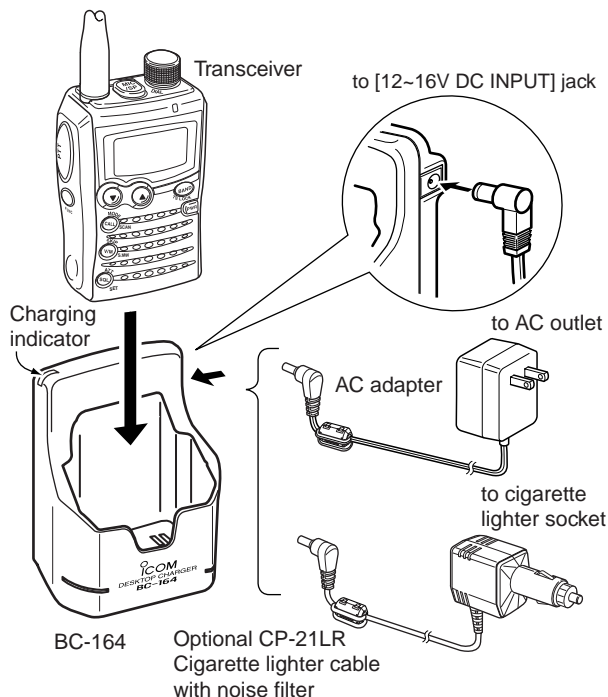



⚠ WARNING!:
NEVER charge any other than the specified battery pack.

◇ Charging description

- ① Plug the AC adapter into an AC outlet; or the optional CP-21LR into a cigarette lighter socket.
- ② Insert the adapter plug into **[12~16V DC INPUT]** of the BC-164 BATTERY CHARGER.
- ③ Install the BP-243 BATTERY PACK (See left page) to the transceiver
- ④ Be sure to turn OFF the transceiver, then charge the battery with transceiver.
 - Takes approximately 3 hours for fully charge with the supplied BP-243 battery pack.
 - Charging indicator of BC-164 lights or blinks as follows.

Charging indicator status	Charging status
Lights orange	Charging
Lights green	Charging is completed
Blinking red	Charging error*

* It may be charging outside of the specified temperature range: +5°C to +35°C (+41°F to +95°F). Restore the specified temperature range and reinsert the transceiver.

- NOTE:** The transceiver has battery indicator to show the following information.
- No indicator appears when the installed battery pack has ample capacity.
 -  (battery indicator) appears when the battery pack is nearing exhaustion.
 -  blinks when the battery pack must be charged.
 -  and "LOW" indicator appear just before the battery pack is completely discharged and display turns OFF.

QUICK REFERENCE GUIDE

■ Your first contact

Now that you have your IC-P7A ready, you are probably excited to get on the air. We would like to take you through a few basic steps to make your first experience “On The Air” enjoyable.

◇ About default settings

The **[DIAL]** control function can be exchanged with the **[▲]/[▼]** key functions by pushing and holding **[FUNC]** then push **[▲]** or **[▼]**. However, in this QUICK REFERENCE GUIDE, the factory default setting (**[DIAL]** sets operating frequency) is used to simplify the instructions.

◇ Basic operation

1. Turning ON the transceiver

- ➡ Push and hold **[PWR]** for 1 sec. to turn the power ON.
 - Opening indication passes through, then frequency indication appears.

/// The opening indication can be skipped. While pushing and holding **[FUNC]**, push and hold **[PWR]** for 1 sec. to shortcut the opening indication.

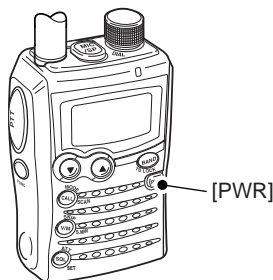

2. Adjusting audio level

- ➡ Push **[▲]/[▼]** to set the desired audio level.

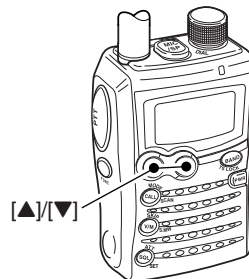

3. Adjusting squelch level

- ➡ While pushing and holding **[SQL]** (**ATT•SET**), rotate **[DIAL]** to set the squelch level.

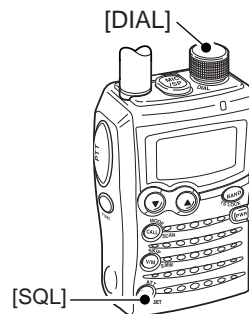

Count on us!