



**VHF DIGITAL VOICE REPEATER**  
**ID-RP2000V**  
**Instruction Manual**

This device complies with Part 15 of the FCC rules. Operation is subject to the following two conditions: (1) This device may not cause harmful interference, and (2) this device must accept any interference received, including interference that may cause undesired operation.

---

## IMPORTANT

---

**CAREFULLY READ THIS INSTRUCTION MANUAL** before installing or operating the ID-RP2000V.

**SAVE THIS INSTRUCTION MANUAL.** This manual contains important safety and operating instructions for the ID-RP2000V.

Refer to the ID-RP2 instruction manual, supplied with the ID-RP2C, for details about D-STAR system repeater instructions, installation and precautions. This instruction manual describes only the ID-RP2000V's particular installation and precautions.

---

## EXPLICIT DEFINITIONS

---

WORD	DEFINITION
<b>⚠ WARNING!</b>	Personal injury, fire hazard or electric shock may occur.
<b>CAUTION</b>	Equipment damage may occur.
<b>NOTE</b>	If disregarded, inconvenience only. No risk or personal injury, fire or electric shock.

---

## PRECAUTIONS

---

**⚠ WARNING RF EXPOSURE!** This device emits Radio Frequency (RF) energy. Extreme caution should be observed when operating this device. If you have any questions regarding RF exposure and safety standards please refer to the Federal Communications Commission Office of Engineering and Technology's report on Evaluating Compliance with FCC Guidelines for Human Radio Frequency Electromagnetic Fields (OET Bulletin 65).

**⚠ WARNING HIGH VOLTAGE! NEVER** touch an antenna or internal antenna connector during transmission. This may result in an electrical shock or burn.

**⚠ WARNING HIGH VOLTAGE! NEVER** install the antenna at any location where a person could easily touch the antenna during transmission. This may result in an electrical shock or burn.

**⚠ WARNING! NEVER** apply AC to the [DC 13.8V IN] connector. This could cause a fire or damage the ID-RP2000V.

**⚠ WARNING! NEVER** apply more than 16 V DC to the [DC 13.8V IN] connector. This could cause a fire or damage the ID-RP2000V.

**⚠ WARNING! NEVER** let metal, wire or other objects touch any internal part or connectors on the ID-RP2000V. This may result in an electric shock or this could cause a fire or damage the ID-RP2000V.

**⚠ WARNING! NEVER** operate or touch the ID-RP2000V with wet hands. This may result in an electric shock or may damage to the ID-RP2000V.

**⚠ WARNING! NEVER** connect the ID-RP2000V to a power source using reverse polarity. This will damage the ID-RP2000V.

Make sure the ID-RP2000V's power is turned OFF when connecting a DC power cable.

**DO NOT** use or place the ID-RP2000V in areas with temperatures below  $-10^{\circ}\text{C}$  ( $+14^{\circ}\text{F}$ ) or above  $+50^{\circ}\text{C}$  ( $+122^{\circ}\text{F}$ ).

**DO NOT** place the ID-RP2000V in excessively dusty environments or in direct sunlight.

**DO NOT** place the ID-RP2000V against walls or putting anything on top of the units. This will obstruct heat dissipation.

**DO NOT** use harsh solvents such as benzine or alcohol to clean the ID-RP2000V, as they will damage the ID-RP2000V's surfaces. If the ID-RP2000V becomes dusty or dirty, wipe it clean with a soft, dry cloth.

**DO NOT** modify the ID-RP2000V for any reason.

Place the ID-RP2000V in a secure place to avoid inadvertent use by children.

Use the specified fuse only.

### ***For the U.S.A. only***

**CAUTION:** Changes or modifications to the ID-RP2000V, not expressly approved by Icom Inc., could void your authority to operate the ID-RP2000V under FCC regulations.

Icom, Icom Inc. and the Icom logo are registered trademarks of Icom Incorporated (Japan) in Japan, the United States, the United Kingdom, Germany, France, Spain, Russia and/or other countries.

Microsoft, Windows and Windows Vista are registered trademarks of Microsoft Corporation in the United States and/or other countries.

All other products or brands are registered trademarks or trademarks of their respective holders.

---

## FOR CLASS B UNINTENTIONAL RADIATORS

---

This equipment has been tested and found to comply with the limits for a Class B digital device, pursuant to part 15 of the FCC Rules. These limits are designed to provide reasonable protection against harmful interference in a residential installation. This equipment generates, uses and can radiate radio frequency energy and, if not installed and used in accordance with the instructions, may cause harmful interference to radio communications. However, there is no guarantee that interference will not occur in a particular installation.

If this equipment does cause harmful interference to radio or television reception, which can be determined by turning the equipment off and on, the user is encouraged to try to correct the interference by one or more of the following measures:

- Reorient or relocate the receiving antenna.
- Increase the separation between the equipment and receiver.
- Connect the equipment into an outlet on a circuit different from that to which the receiver is connected.
- Consult the dealer or an experienced radio/TV technician for help.

---

## TABLE OF CONTENTS

---

IMPORTANT .....	i
EXPLICIT DEFINITIONS .....	i
PRECAUTIONS .....	i
FOR CLASS B UNINTENTIONAL RADIATORS .....	ii
TABLE OF CONTENTS .....	ii
SUPPLIED ACCESSORIES .....	ii
<b>1 SYSTEM OUTLINE .....</b>	<b>1</b>
■ ID-RP2000V .....	1
<b>2 PANEL DESCRIPTIONS .....</b>	<b>2</b>
■ Front panel .....	2
■ Rear panel .....	2
<b>3 INSTALLING AND CONNECTING .....</b>	<b>3–5</b>
■ Attaching a Type-N connector .....	3
■ Power supply requirements .....	3
■ Installing in a system rack .....	4
■ Attaching the rubber feet .....	4
■ Grounding .....	4
■ System connections .....	5

<b>4 INSTALLING THE DRIVERS .....</b>	<b>6–23</b>
■ Microsoft® Windows® 8.1 .....	6
■ Microsoft® Windows® 8 .....	9
■ Microsoft® Windows® 7 .....	12
■ Microsoft® Windows Vista® .....	14
■ Checking the COM port .....	16
■ Uninstalling the USB driver .....	20
<b>5 INSTALLING THE UTILITY SOFTWARE ....</b>	<b>24–26</b>
■ Installing .....	24
■ Uninstalling the Utility software .....	26
<b>6 REPEATER SETTINGS .....</b>	<b>27</b>
■ Frequency setting for ID-RP2000V .....	27
<b>7 MAINTENANCE .....</b>	<b>28</b>
■ Troubleshooting .....	28
■ Cleaning .....	28
■ Replacing fuses .....	28
<b>8 SPECIFICATIONS AND SYSTEM UNITS .....</b>	<b>29</b>
■ Specifications .....	29
■ System units .....	29
<b>9 COUNTRY CODE LIST .....</b>	<b>30</b>

---

## SUPPLIED ACCESSORIES

---

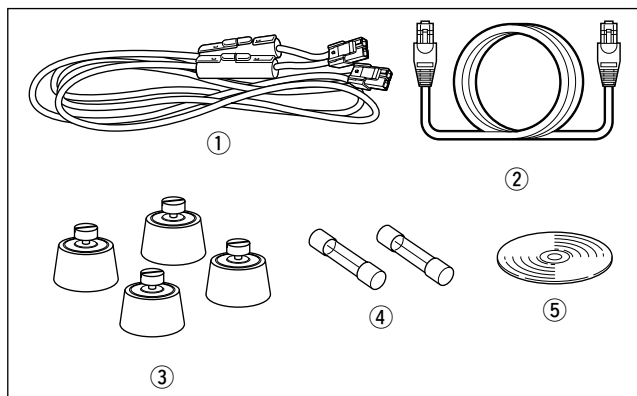

① Power cable (OPC-1309; approx. 1 m; 3.3 ft) .....	1
② Control cable (OPC-1069) .....	1
③ Rubber feet .....	4
④ Spare fuses (FGB10A) .....	2
⑤ Utility CD .....	1

The ID-RP2000V is installed into the Digital Smart Technologies for Amateur Radio (D-STAR) repeater system for operation.

The ID-RP2000V never functions as a repeater without ID-RP2C, due to no relay function is built-in.

## ■ ID-RP2000V

- The ID-RP2000V is a 144 MHz digital voice and slow-speed data repeater (4.8 kbps) and connects to the ID-RP2C.

**NOTE:** No audio CODEC is performed in the ID-RP2000V, thus the ID-RP2000V receives and transmits 4.8 kbps serial data only.

- The ID-RP2000V utility software, supplied with the ID-RP2000V, and a PC are required for both receive and transmit frequency settings.

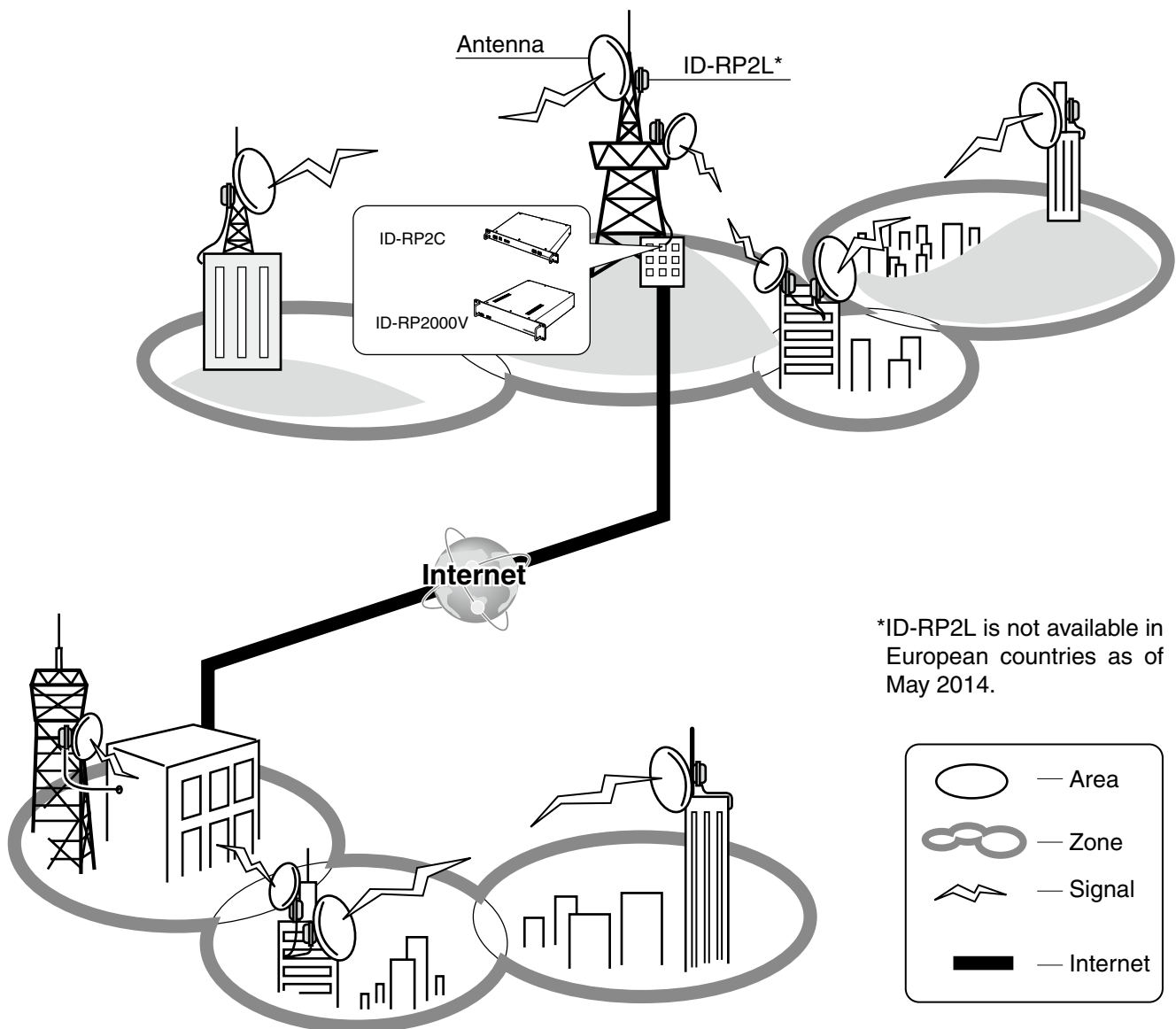

\*ID-RP2L is not available in European countries as of May 2014.

**Count on us!**

#31 (Europe)

<Intended Country of Use>									
<input type="checkbox"/> AT	<input type="checkbox"/> BE	<input type="checkbox"/> CY	<input type="checkbox"/> CZ	<input type="checkbox"/> DK	<input type="checkbox"/> EE				
<input type="checkbox"/> FI	<input type="checkbox"/> FR	<input type="checkbox"/> DE	<input type="checkbox"/> GR	<input type="checkbox"/> HU	<input type="checkbox"/> IE				
<input type="checkbox"/> IT	<input type="checkbox"/> LV	<input type="checkbox"/> LT	<input type="checkbox"/> LU	<input type="checkbox"/> MT	<input type="checkbox"/> NL				
<input type="checkbox"/> PL	<input type="checkbox"/> PT	<input type="checkbox"/> SK	<input type="checkbox"/> SI	<input type="checkbox"/> ES	<input type="checkbox"/> SE				
<input type="checkbox"/> GB	<input type="checkbox"/> IS	<input type="checkbox"/> LI	<input type="checkbox"/> NO	<input type="checkbox"/> CH	<input type="checkbox"/> BG				
<input type="checkbox"/> RO	<input type="checkbox"/> TR	<input type="checkbox"/> HR							